

# Dog Friendly Park

## Albert Park

There are many places in Albert Park where you can walk your dog. As a courtesy to other park users and to help protect the park's wildlife, dog owners should familiarise themselves with the following information.

### Where can I take my dog?

Albert Park is a multi-zone park. Dogs are permitted in most of the park, but must be kept on a lead in some areas and kept out of dog exclusion areas (including the lake and the playgrounds).

#### On lead area

The majority of Albert Park is an on lead area. Dogs must be kept on a lead at all times on the paths and grassed areas surrounding the lake, within picnic areas and within the dog on lead zone.

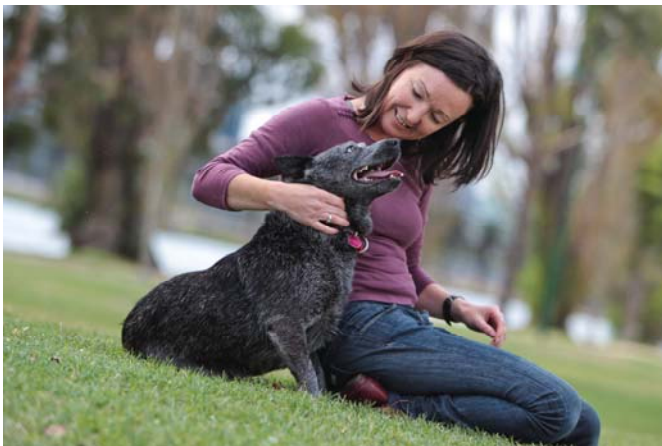

#### Off lead areas

There are two off lead zones within Albert Park. These include the northern end of the park (near Albert Road), and an area to the west of Aughtie Drive (near the sports fields). These two zones are highlighted on the map overleaf. When dogs are in these off lead zones, a lead must be carried to bring the dog under immediate control if necessary. Dog owners must ensure their dogs do not worry, threaten, attack or otherwise interfere with any other person or animal. The areas are off lead only when not being used for sporting activities or events. Owners are responsible for the control of their dogs at all times.

#### Dog exclusion areas

Keep dogs out of the lake and the playgrounds. This is for the health and safety of your dog, visitors, and wildlife.

#### Municipal parks and reserves

You can also walk your dog on and off lead in a nearby municipal park or reserve. Rules apply within each municipality. For further enquiries on council parks and reserves please contact the City of Port Phillip on (03) 9209 6666.

### Dog Friendly Park Code of Conduct

- Consider other park users and ensure that dogs are kept under effective control at all times.
- Carry a lead at all times.
- Bring a friend if you wish to walk with more than two dogs.
- Ensure children are supervised whilst near dogs, as they are vulnerable to attack.
- Ensure your dog's identification, registration and vaccinations are up to date.
- Minimise any disturbance to native fauna, including birdlife in the park.
- Clean up after you dog appropriately.

#### Cleaning up after your dog

Responsible dog owners carry plastic bags to pick up droppings, which can be deposited in bins located around the park.

This significantly reduces the environmental and health risks associated with dog dropping pollution.

### Monitoring the policy

Parks Victoria rangers regularly patrol Albert Park to provide information and education on appropriate dog behaviour. Fines may be issued to dog owners who breach the park regulations.

### Further Information

Thank you for taking responsibility for your dog and complying with park regulations. We hope that you and your dog enjoy your visit to Albert Park.

For further information, visit Parks Victoria online [www.parks.vic.gov.au](http://www.parks.vic.gov.au) or phone 13 1963.

# Albert Park

Map 1



- |                         |                           |
|-------------------------|---------------------------|
| Parking                 | Sealed road               |
| Information             | Sealed path               |
| Toilets                 | Unsealed path             |
| Toilets (weekends only) | Tram / light rail         |
| Picnic table            | Western bike path         |
| Playground              | Underpass                 |
| Boat ramp               | Albert Park               |
| Lookout                 | Waterbody                 |
| Fitness equipment       | Dog off lead area         |
| Cafe                    | Parking                   |
| Drinking fountain       | State Sports Centre Trust |
| BBQ (Electric)          |                           |
| 1 Picnic / event area   |                           |
| E ESTA Emergency marker |                           |
| 131 Tram stop           |                           |
| Tram route              |                           |

[www.parks.vic.gov.au](http://www.parks.vic.gov.au)

Disclaimer: Parks Victoria does not guarantee that this data is without flaw of any kind and therefore disclaims all liability which may arise from you relying on this information. Cartography by Parks Victoria December 2016.

For mobile App search for Avenza PDF Maps



# Albert Park

Map 2

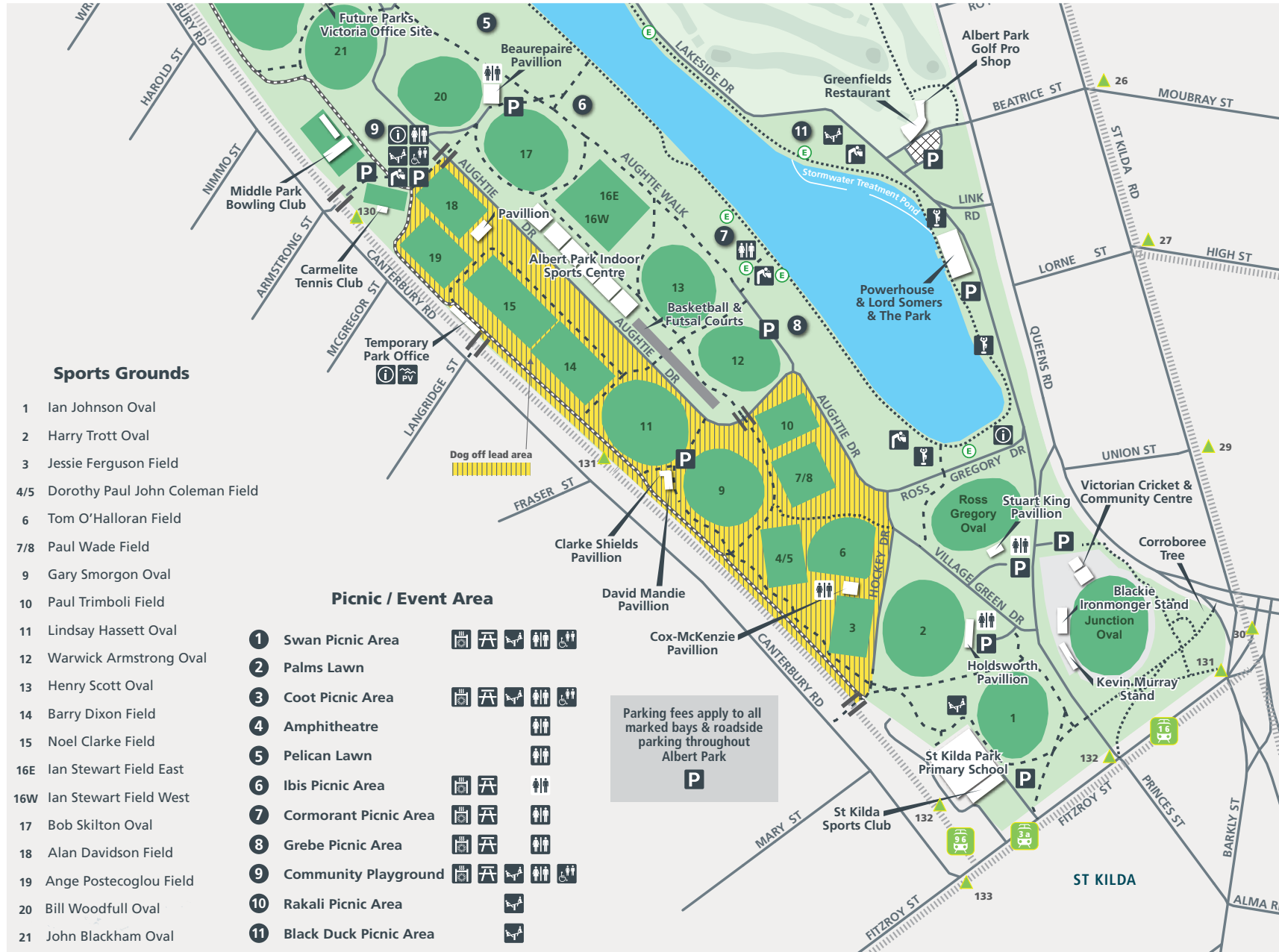

www.parks.vic.gov.au

Disclaimer: Parks Victoria does not guarantee that this data is without flaw of any kind and therefore disclaims all liability which may arise from you relying on this information. Cartography by Parks Victoria December 2016.

For mobile App search for Avenza PDF Maps

