

Albert Park

Visitor Guide



Located only three kilometres from the central business district of Melbourne, Albert Park Reserve is one of Australia's premier recreational parks. The constant motion of walkers, joggers, cyclists, yachts and rowers are all part of the Albert Park scene.



Opening hours

Albert Park is accessible at all times with vehicle, pedestrian and bike access into the park at various locations.

Getting there

Catching the tram is a great way to get to Albert Park. Trams that travel along St Kilda Road all stop within easy walking distance of the park (refer over) and the #12, #96, and #16 trams run past the park from the Melbourne CBD to St Kilda. Limited parking is available for park users in Albert Park. Parking fees apply.

Things to see and do

Walking, jogging and riding

The shared paths in Albert Park are popular with cyclists, joggers and walkers. From shorter walks to connections to significant trail networks of Melbourne.

Lake Path – 4.7km, 45 minutes one way

Walk, jog, or cycle around Albert Park Lake on the park's popular granitic path, taking in spectacular views of the city while passing by the park's wildlife.

Western Bike Path – 3.1km, 25 minutes one way

The Western Bike Path traverses the western edge of Albert Park and links St Kilda with South Melbourne and nearby on-road cycle routes. Part of the trail passes through a dog off lead area.

Picnics and barbecues

Albert Park has nine picnic areas around the picturesque lake, which can be used for picnics, barbecues and functions. Each area has a range of facilities including free electric barbecues, playgrounds, shelters and wide open spaces. Use of these facilities is on a shared basis. All are in close proximity to toilets and parking facilities.

Some activities in Albert Park require a permit (fees may apply). This includes events, commercial filming and photography, major sporting events, various commercial activities and the use of structures, marquees or amusements.

Dogs in the park

There are many places in Albert Park where you can walk your dog. Albert Park is a multi-zone park and dogs are permitted in most of the park, but must be kept on a lead in certain areas, and kept out of dog exclusion areas (including the lake and the playgrounds). You can find these locations on the map overleaf.

Dogs must be kept on a lead at all times on the paths and grassed areas surrounding the lake, in picnic areas and within the dog on lead zone.

There are two off lead zones in Albert Park. When dogs are in the off lead zones, a lead must be carried to bring the dog under immediate control if necessary. Dog owners must ensure that their dogs do not worry, threaten, attack or otherwise interfere with any other person or animal. The areas are off lead only when not being used for sporting activities or events. Owners are responsible for the control of their dogs at all times.

Responsible dog owners carry plastic bags to pick up droppings, which can be deposited in bins located around the park.

Parks Victoria rangers regularly patrol Albert Park to provide information and education on appropriate dog behaviour. Fines may be issued to dog owners who breach the park regulations.

Water sports

Enjoy a day of boating on Albert Park Lake; join a rowing or sailing club or hire a paddle boat.

You can swim, dive or try out the indoor sports facilities and fitness gym at the Melbourne Sports and Aquatic Centre.

Fishing

A variety of native and introduced fish are stocked in Albert Park Lake. A Victorian recreational fishing licence is required and the Victorian Recreational Fishing Guidelines must be followed.

Parks Victoria encourages the 'catch and release' method of fishing to help maintain the water quality within the lake. European Carp (a noxious fish) however must be removed from the lake once caught.

Get Involved

You can join one of the park's volunteer friends groups, the Friends of Redgum Triangle or Save Albert Park, who regularly conduct tree planting, weeding, and other environmental and maintenance activities which enhance the park's ecological values.

Facilities

Albert Park offers an array of picnic areas, playgrounds, dining and sporting facilities, providing for a large diversity of recreational opportunities.

- Join one of the many amateur sporting clubs that use the park's 21 sports fields, or just come along as a spectator.
- Play a round of golf on the Albert Park 18 hole public Golf Course or try out the Golf Driving Range.
- Choose from a wide selection of kiosks, cafés, restaurants, and function centres.
- Visit nearby sporting facilities including the Melbourne Sports and Aquatic Centre, Lakeside Stadium or the Victorian Cricket and Community Centre.

Albert Park

Map 1



- | | |
|-------------------------|---------------------------|
| Parking | Sealed road |
| Information | Sealed path |
| Toilets | Unsealed path |
| Toilets (weekends only) | Tram / light rail |
| Picnic table | Western bike path |
| Playground | Underpass |
| Boat ramp | Albert Park |
| Lookout | Waterbody |
| Fitness equipment | Dog off lead area |
| Cafe | Parking |
| Drinking fountain | State Sports Centre Trust |
| BBQ (Electric) | |
| 1 Picnic / event area | |
| E ESTA Emergency marker | |
| 131 Tram stop | |
| 96 Tram route | |

www.parks.vic.gov.au

Disclaimer: Parks Victoria does not guarantee that this data is without flaw of any kind and therefore disclaims all liability which may arise from you relying on this information. Cartography by Parks Victoria December 2016.

For mobile App search for Avenza PDF Maps



Albert Park

Map 2

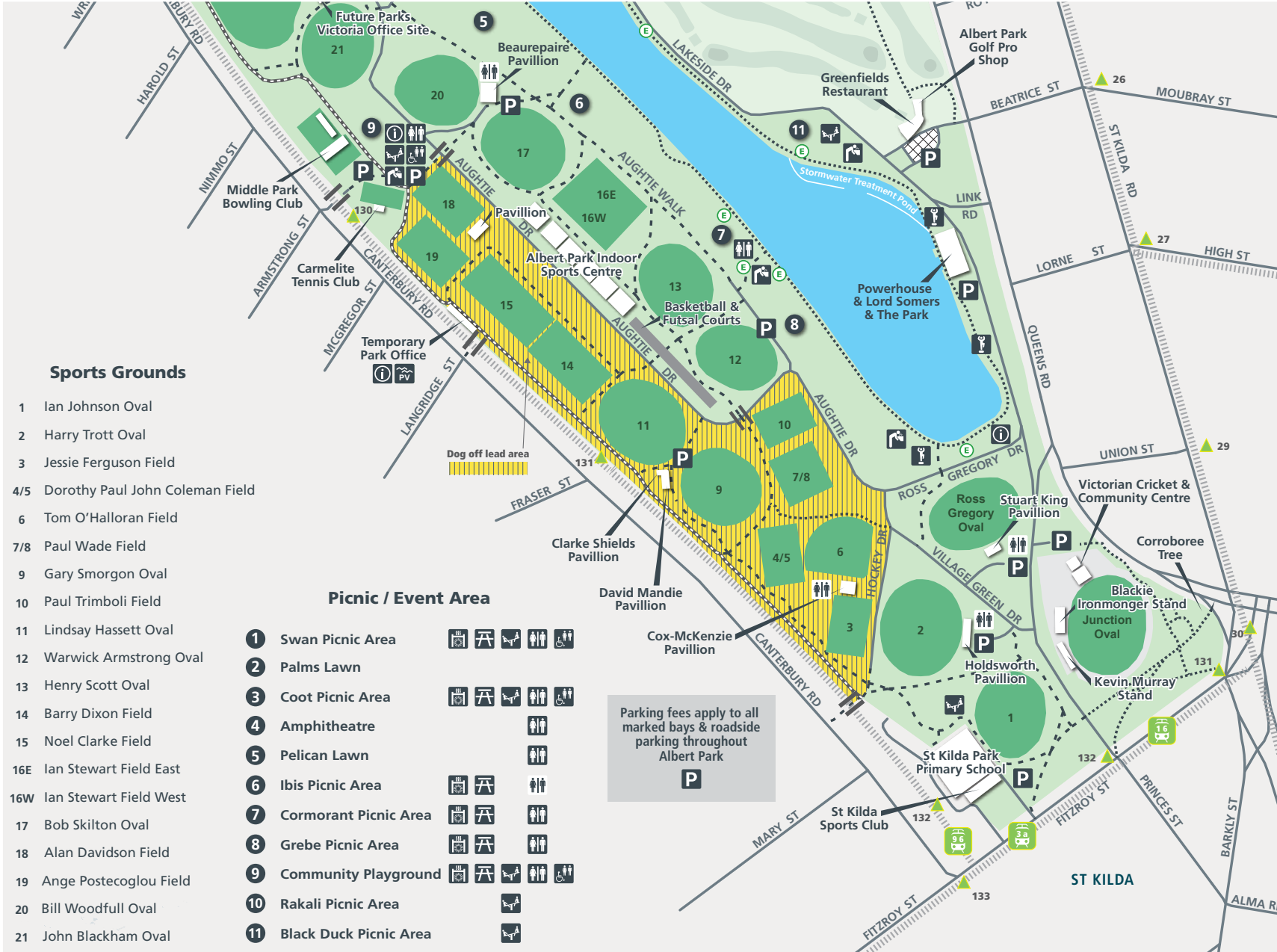

- P** Parking
- i** Information
- ♿** Toilets
- ♿** Toilets (weekends only)
- ♻️** Picnic table
- 🎡** Playground
- 🚤** Boat ramp
- 🔭** Lookout
- 🏋️** Fitness equipment
- ☕** Cafe
- 🚰** Drinking fountain
- 🔥** BBQ (Electric)
- Sealed road
- Sealed path
- Unsealed path
- Tram / light rail
- Western bike path
- Underpass
- Albert Park
- Waterbody
- Dog off lead area
- Parking
- State Sports Centre Trust
- 1 Picnic / event area
- E ESTA Emergency marker
- 131 Tram stop
- 16 Tram route



Events

Albert Park plays host to many national, state-wide and community based recreational, cultural and sporting events.

For further information about hosting an event at Albert Park, please contact Parks Victoria's Statewide Events Branch on events@parks.vic.gov.au or phone 13 1963.

Plants and animals

Albert Park is home to over 5,000 native and introduced trees and grasses. These provide homes for wildlife and beautiful scenery and shade for park users. The large River Red Gum (*Eucalyptus camaldulensis*) situated near the Junction Oval is at least 400 years old.

Within Albert Park Lake, two stormwater treatment ponds control, trap and filter the urban runoff used to fill the lake. The ponds and the lake's other three islands provide habitat for the local bird population, as well as a breeding site for water birds.

Albert Park is a migratory home to significant birds including the Great Egret, the White-throated Needletail and the Sacred Ibis. Black Swans, Pacific Black Ducks, Pelicans, Coots and Cormorants can often be seen feeding on the aquatic vegetation within the lake.

Back on land, Kookaburras, Cockatoos, Rosellas and Magpies can be heard in the trees. If you come by at night you may be lucky enough to see a Ringtail or Brushtail Possum venturing from their trees to find food.

Caring for Albert Park

Help us look after your parks by following these guidelines:

- Please place all rubbish in the bins provided.
- Observe all regulations for dogs; dogs must be kept on a lead unless otherwise stipulated.
- Clean up after your dog.
- Do not feed the wildlife, including all water birds.
- Vehicles are not permitted on the ovals, open space or grassed areas at any time.
- Golf is only permitted within the Golf Course and Golf Driving Range
- All native plants and animals are protected by law.
- Camping is not permitted within Albert Park.
- Portable solid fuel barbecues are not permitted, however portable gas barbecues may be used.

Be prepared and stay safe

Albert Park is in the Central fire district. Bushfire safety is a personal responsibility. Anyone entering parks and forests during the bushfire season needs to stay aware of forecast weather conditions. Check the Fire Danger Rating and for days of Total Fire Ban at www.emergency.vic.gov.au, on the VicEmergency smartphone app or call the VicEmergency Hotline on 1800 226 226. No fires may be lit on Total Fire Ban days.

For emergency assistance call Triple Zero (000). If there is a green emergency marker sign near you, read the information on the marker to the operator.